



Optional Thermowell

Description & Features:

- Measures both pressure and temperature on the same dial
- 2.5" (63mm) and 3" (75mm) dials
- Dual scale (°F & °C)
- Back or bottom connection
- Brass wetted parts
- 1" (25mm), 2" (50mm) and 2.5" (63mm) stems
- Multiple pressure and temperature ranges available
- Can be used with TST thermowells
- Ranges are compliant to industry standard ASME Boiler Code Section IV HG-612
- 5 year warranty

Applications:

- Hot water and steam pressure for boilers

Specifications

| | |
|----------------------------|---|
| Dial | 2.5" (63mm), 3" (75mm) aluminum, painted white |
| Case | Steel, painted black |
| Lens | 2.5" (63mm): Acrylic, threaded 3" (75mm): Glass |
| Ring | 3" (75mm): Chrome |
| Stem | Brass |
| Socket | Brass |
| Tube | Phosphor bronze |
| Movement | Brass and phosphor bronze |
| Sensing Element | Temperature: Bi-metallic coil Pressure: Bourdon tube |
| Pointer | Aluminum, anodized black |
| Welding | Tin-alloy solder |
| Pressure Limit | 75% of full scale range |
| Ambient Temperature | 23°F to 122°F (-5°C to 50°C) |
| Process Temperature | 75% of full scale range |
| Accuracy | Pressure: ±3-2-3% Temperature: ±3% of full scale |
| Enclosure Rating | IP50 |

Order Codes (products in bold are normally stock in North America)

| Range | Dial | Connection | Stem Length | Code | Tridicator Shut-off Thermowell |
|---|-------------|--------------------------|-------------|---------------|--------------------------------|
| 0-75psi/kPa, 70°F to 320°F & 20°C to 160°C | 2.5" (63mm) | 1/4" NPT, Back | 1" (25mm) | TTD410 | - |
| 0-75psi/kPa, 70°F to 320°F & 20°C to 160°C | 2.5" (63mm) | 1/4" NPT, Extension Back | 2" (50mm) | TTD401 | TST025 |
| 0-75psi/kPa, 70°F to 320°F & 20°C to 160°C | 2.5" (63mm) | 1/4" NPT, Back | 2" (50mm) | TTD404 | |
| 0-75psi/kPa, 70°F to 320°F & 20°C to 160°C | 3" (75mm) | 1/2" NPT, Bottom | 2.5" (63mm) | TTD403 | |
| 0-75psi/kPa, 70°F to 320°F & 20°C to 160°C | 3" (75mm) | 1/2" NPT, Back | 2.5" (63mm) | TTD402 | |
| 0-100psi/kPa, 70°F to 320°F & 20°C to 160°C | 3" (75mm) | 1/2" NPT, Bottom | 2.5" (63mm) | TTD409 | |
| 0-100psi/kPa, 70°F to 320°F & 20°C to 160°C | 3" (75mm) | 1/2" NPT, Back | 2.5" (63mm) | TTD408 | TST050 |
| 0-200psi/kPa, 70°F to 320°F & 20°C to 160°C | 3" (75mm) | 1/2" NPT, Bottom | 2.5" (63mm) | TTD405 | |
| 0-200psi/kPa, 70°F to 320°F & 20°C to 160°C | 3" (75mm) | 1/2" NPT, Back | 2.5" (63mm) | TTD407 | |
| 0-250psi/kPa, 70°F to 320°F & 20°C to 160°C | 3" (75mm) | 1/2" NPT, Bottom | 2.5" (63mm) | TTD399 | |
| 0-250psi/kPa, 70°F to 320°F & 20°C to 160°C | 3" (75mm) | 1/2" NPT, Back | 2.5" (63mm) | TTD398 | |

Other ranges, stem lengths, dial and connection sizes available upon request.

Option suffix:

TST025 = 1/4" brass thermowell

TST050 = 1/2" brass thermowell

2.5" Back Connection, 1" Stem

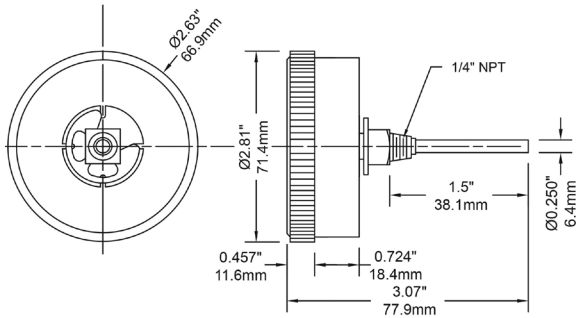

2.5" Back Connection

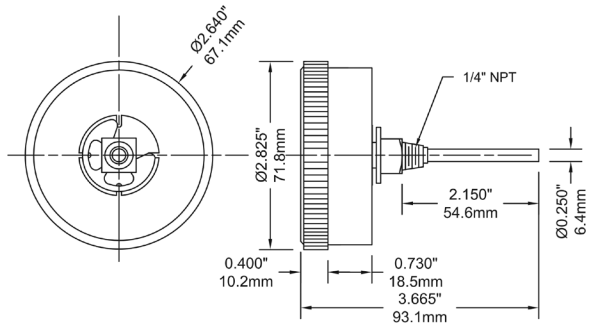

2.5" Extension Back Connection

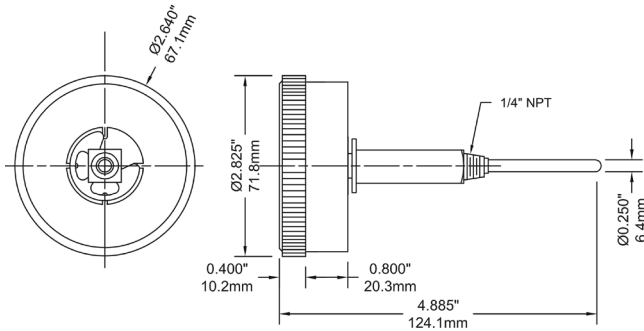

3" Bottom Connection

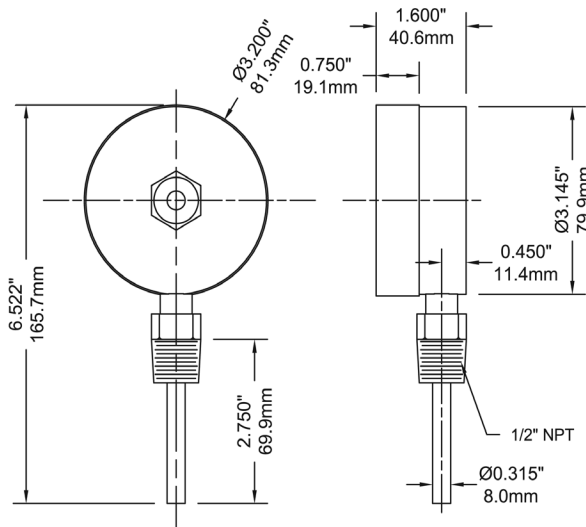

3" Back Connection

