



Optional Case

### Description & Features:

- Highly accurate:  $\pm 0.25\%$  for 6" (150mm),  $\pm 0.50\%$  for 4" (100mm) complete with calibration certificate traceable to NIST standards
- Mirrored anti-parallax dial
- Knife-edge pointer
- Protective carrying and storage case available
- ASME B40.100 compliant
- CRN registered
- 5 year warranty

### Applications:

- Designed to be used where accuracy and repeatability are of prime importance
- Used in laboratories and instrument testing facilities

### Specifications

<b>Dial</b>	4" (100mm), 6" (150mm) white aluminum with black markings Both dials have mirror band for precise instrument readings
<b>Case</b>	AISI 304 SS
<b>Lens</b>	Polycarbonate
<b>Ring</b>	AISI 304 SS
<b>Socket</b>	4" (100mm): Brass 6" (150mm): 316 SS
<b>Connection</b>	1/4" NPT or 1/2" NPT standard, bottom
<b>Bourdon Tube</b>	4" (100mm): Phosphor bronze 6" (150mm): 316 SS
<b>Movement</b>	4" (100mm): Brass 6" (150mm): AISI 304 SS temperature compensated
<b>Pointer</b>	Aluminum, anodized black, micrometer adjustable, knife-edge
<b>Welding</b>	Silver alloy (TIG for 316 SS wetted parts)
<b>Over-pressure Limit</b>	30% of full scale value
<b>Working Pressure</b>	Maximum 75% of full scale value
<b>Calibration Conditions</b>	68°F ( $\pm 5.4^\circ\text{F}$ ), 20°C ( $\pm 3^\circ\text{C}$ ) for ambient and process temperatures at atmospheric pressure
<b>Ambient/Process Temperature</b>	-4°F to 150°F (-20°C to 65°C)
<b>Accuracy</b>	4" (100mm): $\pm 0.5\%$ ANSI/ASME Grade 2A 6" (150mm): $\pm 0.25\%$ ANSI/ASME Grade 3A
<b>Enclosure Rating</b>	IP65

### Order Codes

Dial Size	4" (100mm)		6" (150mm)	
Tube	Phosphor Bronze		316 SS	
Movement	Brass		304 SS temperature compensated	
Connection	1/4" Bottom	1/2" Bottom	1/4" Bottom	1/2" Bottom
30" Hg Vac	PTG3999	-	PTG1999	PTG2055
0/15 psi	PTG4000	-	PTG2000	PTG2056
0/30 psi	PTG4001	-	PTG2001	PTG2057
0/60 psi	PTG4002	-	PTG2002	PTG2058
0/100 psi	PTG4003	-	PTG2003	PTG2059
0/160 psi	PTG4004	-	PTG2004	PTG2060
0/200 psi	PTG4005	-	PTG2005	PTG2061
0/300 psi	PTG4006	-	PTG2006	PTG2062
0/400 psi	PTG4007	-	PTG2007	PTG2063
0/600 psi	PTG4008	-	PTG2008	PTG2064
0/1,000 psi	-	PTG4009	PTG2016	PTG2009
0/1,500 psi	-	PTG4010	PTG2017	PTG2010
0/2,000 psi	-	PTG4011	PTG2018	PTG2011
0/3,000 psi	-	PTG4012	PTG2019	PTG2012
0/5,000 psi	-	PTG4013	PTG2053	PTG2013
0/10,000 psi	-	PTG4014	PTG2054	PTG2014

Other ranges and connection sizes available upon request. For scale change, refer to How to Order Guide for scale codes.

**For options, attach suffix to end of order code: i.e. PTG2006-B for BACK CONNECTION**

**Option suffix:**

4BF = 4" (100mm) Back flange

4FF = 4" (100mm) Front flange

4UC-P = 4" (100mm) U-Clamp premium

6BF = 6" (150mm) Back flange

6FF = 6" (150mm) Front flange

B = Back connection

TG4 = 4" (100mm) Test gauge case

TG6 = 6" (150mm) Test gauge case

### 4" Bottom Connection with Back Flange

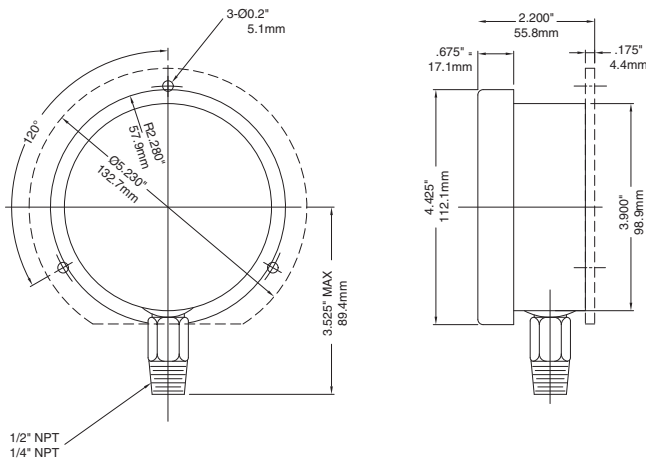

### 6" Bottom Connection with Back Flange

